

Operator's manual

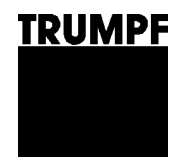

TruTool C 250 (1B5) Recharger CLi

English



Contents

1.	Safety	4
1.1	General safety information.....	4
1.2	Specific safety information.....	5
2.	Description	6
2.1	Intended use	7
2.2	Technical data	8
3.	Setting work	9
3.1	Selection of tools	9
3.2	Loading the rechargeable battery.....	11
3.3	Changing the battery	14
4.	Operation	15
4.1	Working with the TruTool C 250	16
5.	Maintenance	19
5.1	Replacing the tool	20
	Replacing the blade	21
	Turning or replacing the insertable cutters	21
5.2	Replacing the cutter plate	21
6.	Original accessories and wearing parts.....	22

Guarantee

Replacement parts list

Addresses

1. Safety

1.1 General safety information

- Read the operator's manual and the safety information (Order No. 125699) in their entirety before starting up the machine. Closely follow the instructions given.
- Adhere to the safety regulations in accordance with DIN VDE, CEE, AFNOR and to the specific regulations of the country of operation.



Danger

Risk of fatal injury from electric shock.

- Do not touch the electrical contacts on the recharger or on the rechargeable battery.
-



Warning

Risk of injury from the rechargeable battery.

- Always remove the rechargeable battery from the machine prior to maintenance work.
 - Check the machine and the rechargeable battery for damage each time before use.
 - Keep the machine dry and do not operate it in damp rooms.
 - Charge the exchangeable battery of the Li-Ion Energy 28 V system only with the recharger of the Li-Ion Energy 28 V system.
 - Do not attempt to open the exchangeable batteries or the recharger.
 - Do not dispose of the exchangeable batteries in fires or household waste.
-



Warning

Risk of injury due to improper handling.

- Wear safety glasses, hearing protection, protective gloves and work shoes when working at the machine.
-



Caution

Damage to property due to improper handling.

The machine will be damaged or destroyed.

- Have servicing and inspections of hand-held electric tools and recharger carried out by a qualified specialist. Only use original TRUMPF accessories.
-

1.2 Specific safety information



Warning

Risk of injury due to improper handling.

- Make sure the machine is always in a stable position when operating it.
 - Never touch the tool while the machine is running.
 - Always operate the machine away from your body.
 - Do not operate the machine above your head.
-



Warning

Risk of injury to hands.

- Do not reach into the processing line with your hands.
 - Use both hands to hold the machine.
-

2. Description

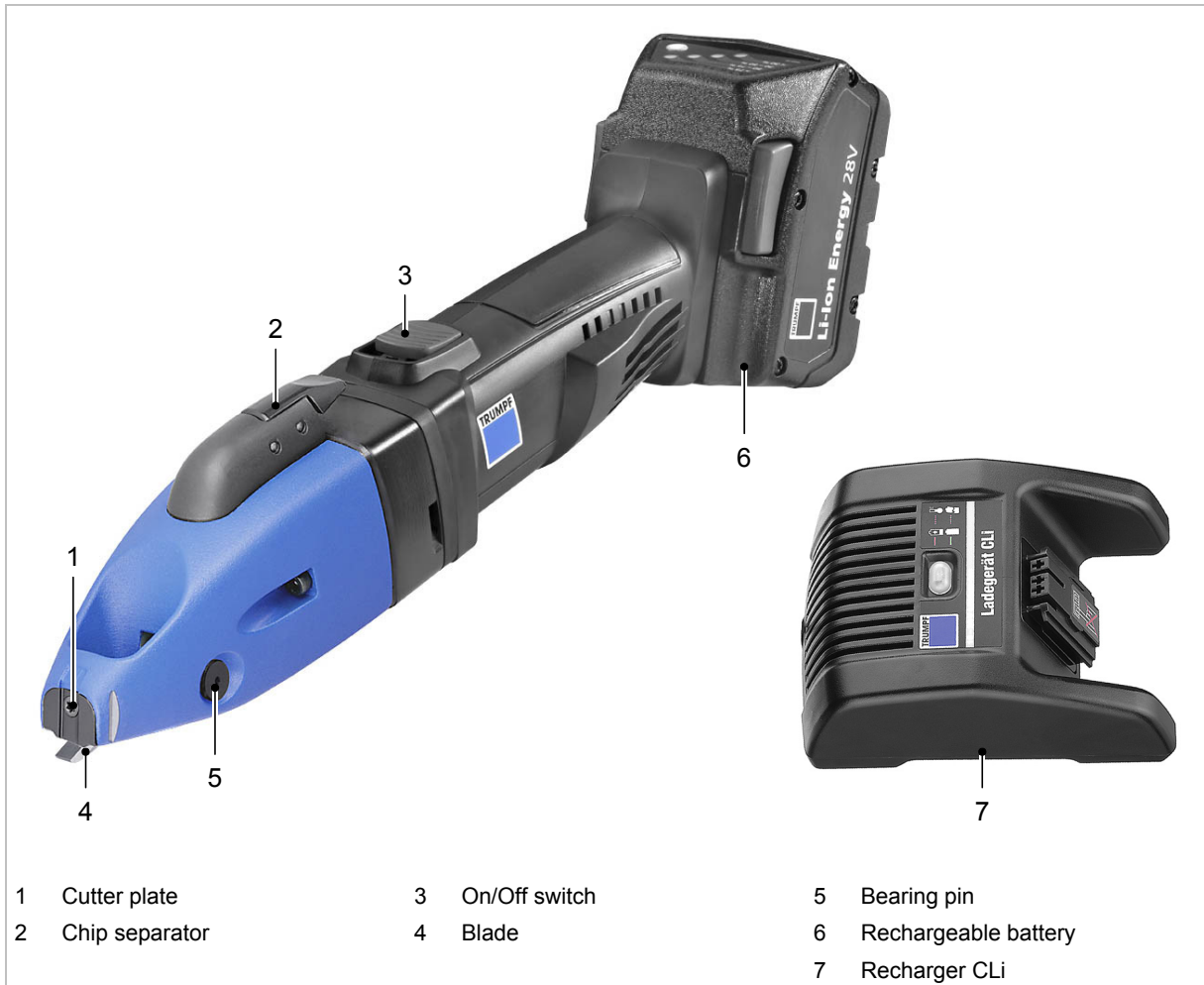

Slitting shears TruTool C 250 with recharger

Fig. 53344

2.1 Intended use

**Warning**

Can cause injury or damage to health!

- Only use the machine for work and materials described in "Intended use".
 - Do not process materials containing asbestos.
-

The TRUMPF Slitting Shears TruTool C 250 is an electrical hand-held device used for the following applications:

- Cutting plate-shaped workpieces made of steel, aluminum, plastic, etc.
- Cutting straight or curved exterior and interior cutouts.
- Cutting along scribed lines.

The TRUMPF TruTool C 250 Slitting Shears enable chips to be cut off that are produced while machining the workpiece as required.

The CLi recharger charges exchangeable batteries of the Li-Ion Energy 28 V system.

2.2 Technical data

	Other countries	USA
	Values	Values
Voltage	28 V	28 V
Permissible material thickness		
• Steel up to 400 N/mm ²	2.5 mm	0.098 in
• Steel up to 600 N/mm ²	1.5 mm	0.059 in
• Aluminum 250 N/mm ²	3.0 mm	0.118 in
Working speed	3-6 m/min	10-20 ft/min
Weight with rechargeable battery	3.3 kg	7.3 lbs
Weight without rechargeable battery	2.3 kg	5.1 lbs
Start hole diameter	25 mm	0.98 in

Technical data TruTool C 250

Tab. 1

Voltage	28 V
Loading time at 28 V	approximately 1 h
Weight without power cord	700 g

Technical data CLi recharger

Tab. 2

Vibration	Specifications in accordance with EN 12096 Measured values in accordance with EN ISO 8662-10
Vibration value at the handle a	6.2 m/s ²
Uncertainty K	1.5 m/s ²

Tab. 3

Measured values were measured while machining sheet steel 400 N/mm² with max. material thickness.

Noise emissions	Specifications in accordance with EN ISO 4871 Measured values in accordance with EN ISO 15744
A-rated sound level L _{WA}	106 dB
A-rated acoustic power level at the work place L _{PA}	92 dB

Tab. 4

The noise emission values given are the sum of the measured values and the corresponding uncertainties. They represent an upper value limit which can emerge during measurements.

3. Setting work

3.1 Selection of tools

Note

The blades have 2 cutting edges. They cannot be resharpened.

Different types of blades are required, depending on the material thickness or the tensile strength of the workpiece. (See Tab. 5, p. 10.)

Note

If the blade is not selected as specified in the table,

- The cutting quality will be severely impaired.
- If the feed power increases significantly.
- The blade will break.



Tool type	Description	Material thickness in mm	Radius	Order no.
	Straight blade 1.5 – 2.5 mm	Aluminum max. 250 N/mm ² 1.5 to 3.0 Steel max. 400 N/mm ² 1.5 to 2.5	150	1273341
	Straight blade - 1.5 mm	Aluminum max. 250 N/mm ² 0.5 to 2.0 Steel max. 400 N/mm ² 0.5 to 1.5	80	1258006
	Curve blade - 1.5 mm	Aluminum max. 250 N/mm ² 0.5 to 2.0 Steel max. 400 N/mm ² 0.5 to 1.5	45 left 80 right	1260101
	Blade CR	Stainless steel max. 600 N/mm ² 0.5 to 1.5	120	1278387
	Blade SC (parallel fold)	Steel max. 400 N/mm ² 4x0.9 Stainless steel max. 600 N/mm ² ¹ 4x0.6	150	1260102
	Insertable cutters (1 set = 2 pieces)	All materials		1275275
	Cutter plate	All materials		1267770
	Screw	All materials		0350327

Blade selection

Tab. 5

¹ If possible, do not cut chips on the lock seam. That would reduce the service life.

3.2 Loading the rechargeable battery



Risk of fatal injury from electric shock.

Line voltage is present at the battery terminals.

- Do not touch the electrical contacts (battery terminals) on the recharger.

The rechargeable battery is partially charged (50%) at the time the rechargeable battery electric tool is delivered.

Checking loading status

Prerequisites

- The electric tool has been switched off for at least 1 minute.
- Press the key on the rechargeable battery.

The LEDs on the rechargeable battery show the charging status.

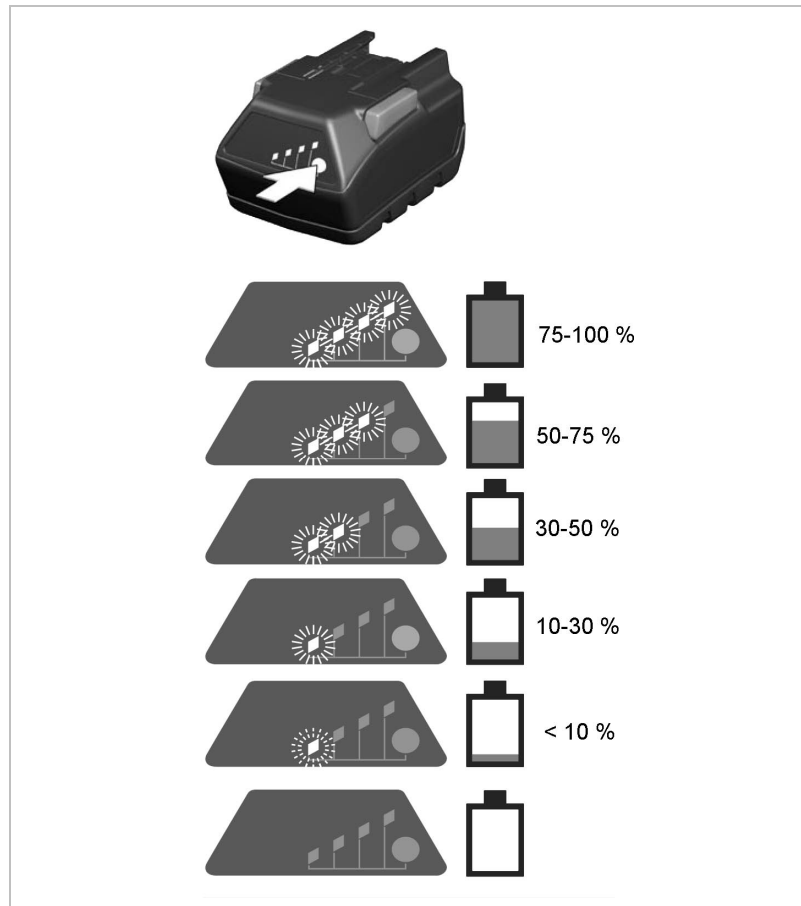

Check of charging status on the rechargeable battery

Fig. 53299



Loading the rechargeable battery

Before using the cordless electric tool, a new exchangeable battery or one that has not been used for a long time needs to be charged.

Note

The full capacity is reached after 2-10 charging cycles.



Fig. 53300

- Insert the exchangeable battery into the insertion well on the recharger.

The loading time is between 1 min and 60 min, depending on how far the rechargeable battery had been discharged beforehand. The rechargeable battery is completely charged after 60 min.

The maximum charging current flows when the temperature of the rechargeable battery is between 0°C and 66°C. If a rechargeable battery is inserted into the recharger that is too cold or too warm (red LED flashes), then the charging process will begin automatically as soon as the rechargeable battery has reached the correct charging temperature (-10°C to +66°C).



Status display on the recharger



1 Status display

Recharger CLi

Fig. 53306

Display	Function
Red continuous	Loading
Green continuous	Rechargeable battery is full
Red, flashing	Rechargeable battery too warm/cold
Flashing red and green	Error in the rechargeable battery

Tab. 6

3.3 Changing the battery

Removing the exchangeable battery

- Press the locking mechanism (1) together and pull the exchangeable battery out and upwards.

Inserting the exchangeable battery

- Slide the exchangeable battery into the machine holder from above until the battery locks into place.

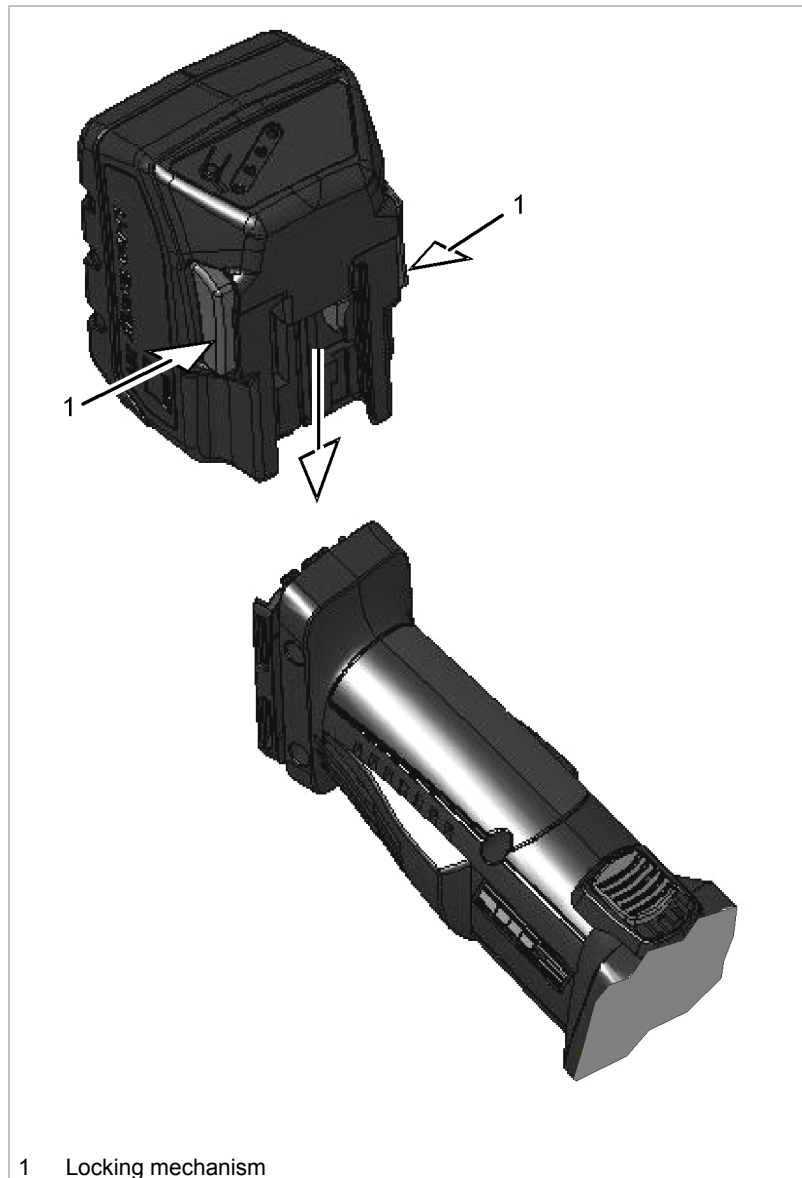

Fig. 53321

4. Operation



Warning

Risk of injury due to improper handling.

- Make sure the machine is always in a stable position when operating it.
 - Wear safety glasses, hearing protection, protective gloves and work shoes when working at the machine.
 - Never touch the tool while the machine is running.
 - Always operate the machine away from your body.
 - Do not operate the machine above your head.
-



Caution

Damage to property caused by blunt tools.

Machine overload.

- Check the cutting edge of the blade hourly for wear. Sharp blades ensure good cutting quality and protect the machine.
 - Replace the blades in due time.
-

4.1 Working with the TruTool C 250

Before using the cordless electric tool, a new exchangeable battery or one that has not been used for a long time needs to be activated.

Activating rechargeable battery

- Place rechargeable battery briefly on the recharger or charge it completely.

The LEDs on the rechargeable battery show the charging status.

Note

The performance capacity of the rechargeable battery is available to only a limited extent at temperatures below -10°C .

Discharging the rechargeable battery

The rechargeable battery shuts off automatically when it is completely discharged. The rechargeable battery emits brief electricity pulses when the electrical tool is switched on.

Switching on the TruTool C 250

Note

Do not move the machine towards the workpiece until full speed has been reached.

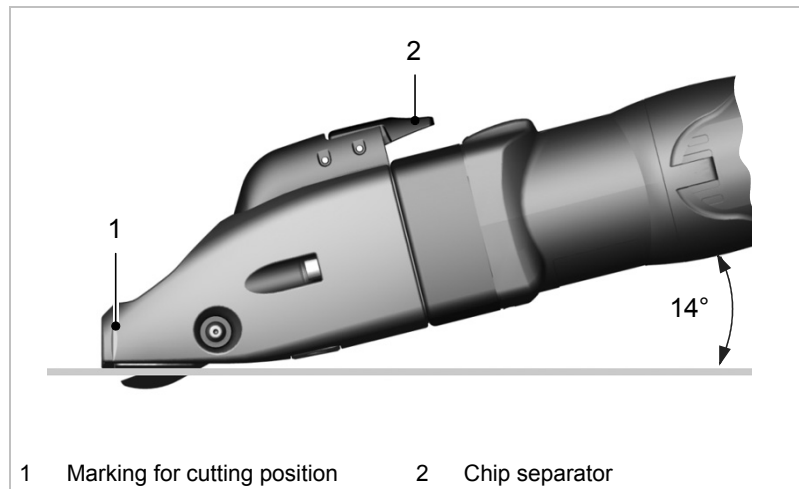

Fig. 37735

1. Slide the On/Off switch forwards.
2. Guide the machine at an angle of about 14° to the sheet surface.

**Note**

If the electric tool does not work after being switched on, stick the rechargeable battery on the recharger and check the charging status.



1 Charging status

Rechargeable battery Li-Ion Energy 28 V

Fig. 53294

Note

Do not subject the machine to heavy loads to such an extent that it stops.

Never operate the machine without blades.

To protect the machine and for a good cutting performance:

- Ensure that blades are sharp.
- Turn insertable cutters in due time.
- Change insertable cutters in due time.

The following applies when cutting radii:

- Do not tilt the machine.
- Only operate at a low feed rate.

Cutting off chips

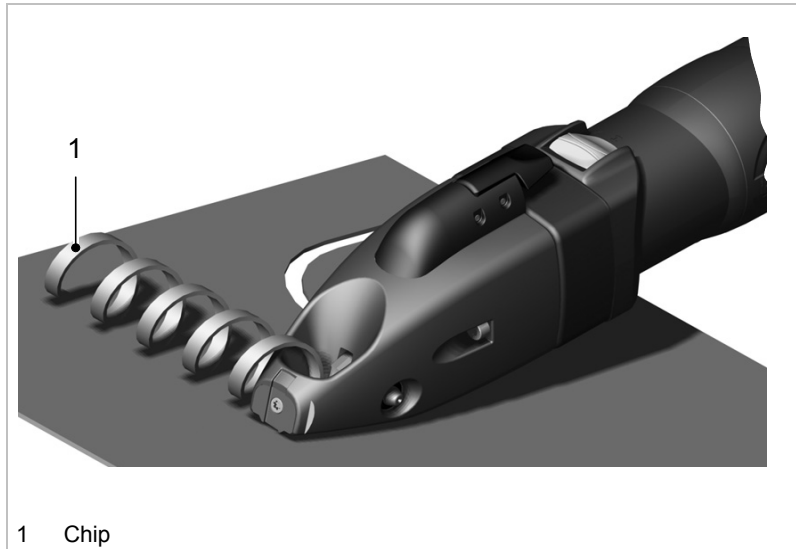

Fig. 37734

- Press the cut-off switch for approx. 0.5 s while the machine is running. The cutting process is stopped automatically.

Note

Do not cut off small chips. The minimum length of a chip must be at least one full turn.
Remove the chip manually.

Note

The front part of the casing has a marking that indicates the cutting position.

Switching off the TruTool C 250

- Slide the On/Off switch to the rear.

5. Maintenance



Warning

Risk of injury from the rechargeable battery.

- Remove rechargeable battery when changing tools and before performing any maintenance work on the machine.
-



Warning

Risk of injury due to incorrect repair work.

Machine does not work properly.

- Repair work may only be carried out by a qualified technician.
-



Caution

Damage to property caused by blunt tools.

Machine overload.

- Check the cutting edge of the blade hourly for wear. Sharp blades ensure good cutting quality and protect the machine.
 - Replace the blades in due time.
-

Maintenance point	Procedure and interval	Recommended lubricant	Lubricant order no.
Bearing pin	Lubricate when replacing the blade	Lubricating grease "G1"	0139440
Blades	Lubricate when replacing the blades	Lubricating grease "G1"	0139440
Gear, gear head and cutter	After 300 operating hours, arrange for a qualified technician to relubricate or to replace the lubricating grease	Lubricating grease "G1"	0139440
Insertable cutters	Turn as needed	-	-
Insertable cutters	Replace as needed	-	-
Blades	Replace as needed	-	-
Cutter plate	Replace as needed	-	-
Rechargeable battery	Replace as needed	-	-

Maintenance positions and maintenance intervals

Tab. 7

5.1 Replacing the tool

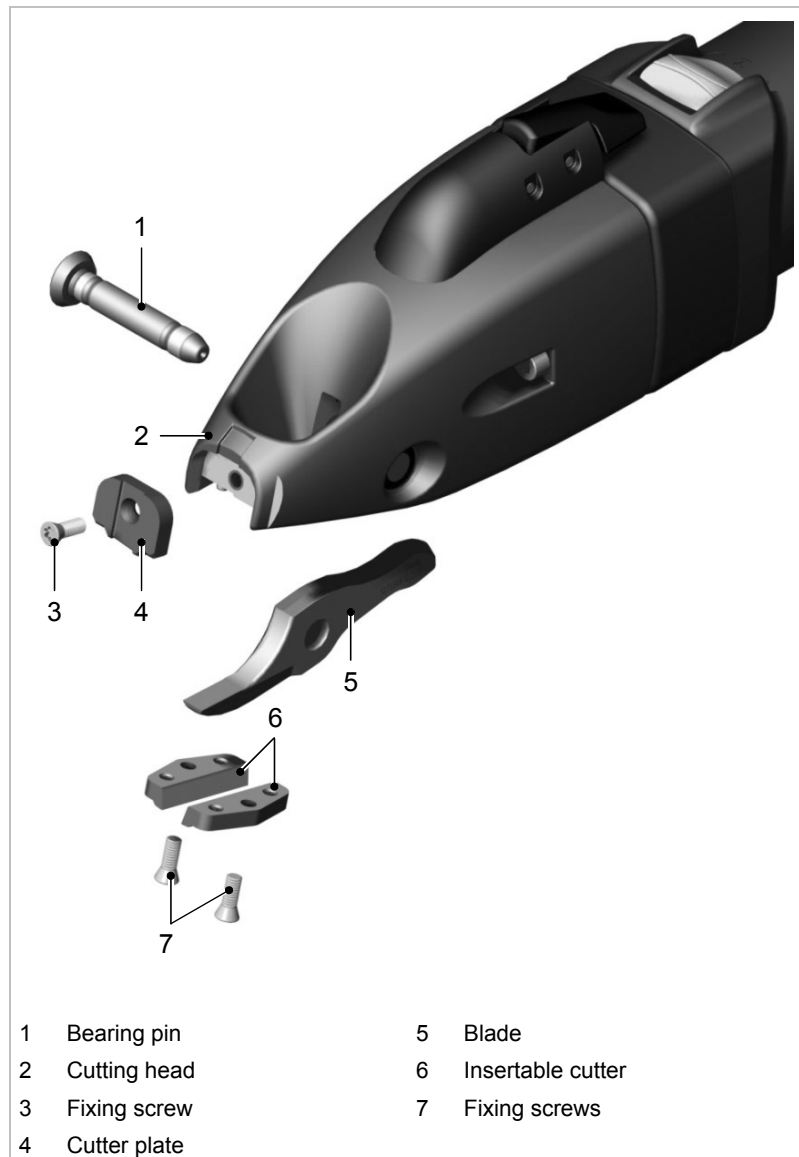

Replacing the tool

Fig. 37728

Replacing the blade



Caution

Damage to property caused by blunt tools.

Machine overload.

- Check the cutting edge of the blade hourly for wear. Sharp blades ensure good cutting quality and protect the machine. Replace the blades in due time.
-

If the cutting edges are blunt, replace the blades.

1. Push out the engaged bearing pin (1st position).
2. Pull the blade out of the cutting head.
3. Apply a thin layer of grease to the bearing pin and the new blade.
4. Insert the new blade.
5. Push the bearing bolt into the bore hole until it locks into place.

Turning or replacing the insertable cutters

1. Undo the fixing screws.
2. Check the insertable cutters:
 - If a cutting edge is blunt: turn the insertable cutters through 180° (change the left insertable cutter to the right side and the right insertable cutter to the left side).
- or**
- If both cutting edges of an insertable cutter are blunt, replace the insertable cutters.
3. Tighten the fixing screw.

5.2 Replacing the cutter plate

1. Undo the fixing screws.
2. Replace the cutter plate.
3. Tighten the fixing screws.

6. Original accessories and wearing parts

TruTool C 250	Supplied original accessories	Wearing parts	Options	Order number
Insertable cutters (2 x)	+	+		1275275
Straight blade 1.5 – 2.5 mm	+	+		1273341
Straight blade 0.5 – 1.5 mm		+		1258006
Curve blade		+		1260101
Blade CR (for cutting high-tensile sheets)		+		1278387
Blade SC (parallel fold)		+		1260102
Cutter plate	+	+		1267770
Case	+			1470139
Operator's manual	+			1467653
Safety information	+			0125699
Torx 20x60 wrench	+			0359907
Rechargeable battery 28 V	+			1464697
Recharger CLi 220-240 V	+			1464702
Recharger CLi 120 V	+			1464703

Tab. 8

Ordering wearing parts To ensure the correct and fast delivery of original parts and wearing parts:

1. Specify the order number.
2. Enter further order data:
 - Voltage data.
 - Quantity
 - Machine type.
3. Specify the complete shipping information:
 - Correct address.
 - Desired delivery type (e.g. air mail, courier, express mail, ordinary freight, parcel post).
4. Send the order to the TRUMPF representative office. For TRUMPF service addresses, see www.trumpf-powertools.com.